

## INSTALLATION INSTRUCTIONS

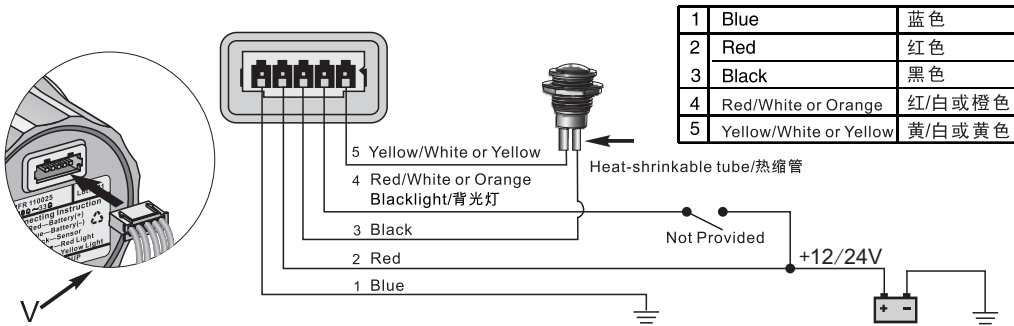
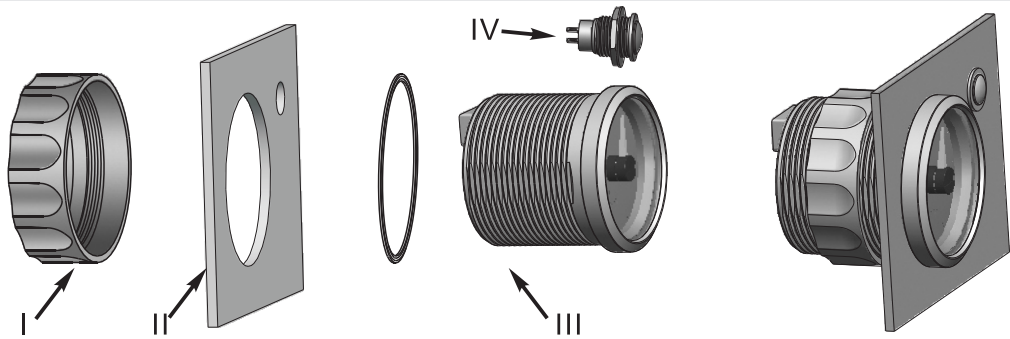

### INSTALLATION STEPS

1. Open 2 (∅52mm&∅12mm) holes on cabin board or gauge panel (# II) which the .
2. Put gauge(# III) inside panel(# II) and then screw it tight by fixing ring.
3. Lay button(# IV) inside panel(# II), screw it down by nut.
4. Connecting cables according to wiring diagram. Mount heat-shrinkable tube after button pin welded with cable. Gauge can be directly connected with DC12/24V power supply.
5. Link wiring harness(#V) at gauge port
6. Press button and adjust time.
7. This clock gauge has no backup battery in itself, so please connect clock gauge with incessant power. Time should be re-adjusted if incessant power is changed.

### 安装步骤

1. 在您的船舱板或仪表板面板(# II)上开一个直径52 mm和直径12mm的孔。
2. 将仪表(# III)装入面板(# II)中, 再用固定圈(# I)旋紧即可。
3. 将按钮(# IV)装入面板(# II)中, 再用螺母锁紧。
4. 按接线图将电线连接好, 按钮的引脚与电线焊接好后, 请套上热缩管。仪表可直接连接到DC12/24V的电源上。
5. 将线束(#V)接入仪表端口中。
6. 按动按钮, 调整到正确的时间。
7. 时钟表本身无备用电池, 故请将时钟表电源直接连接到不断电的电源上! 如果更换电源, 则在重新上电后需要重新调整时间。

## INSTALLATION INSTRUCTIONS

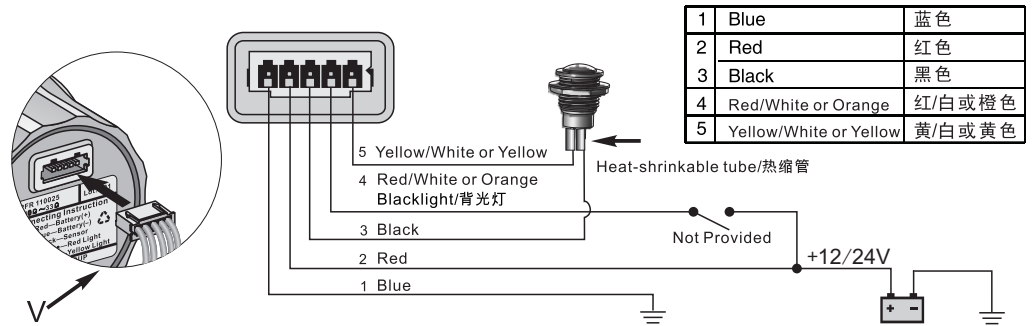
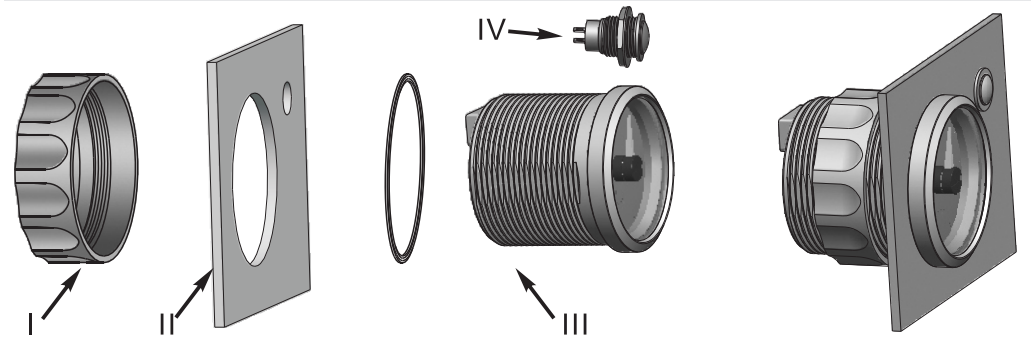

### INSTALLATION STEPS

1. Open 2 (∅52mm&∅12mm) holes on cabin board or gauge panel (# II) which the .
2. Put gauge(# III) inside panel(# II) and then screw it tight by fixing ring.
3. Lay button(# IV) inside panel(# II), screw it down by nut.
4. Connecting cables according to wiring diagram. Mount heat-shrinkable tube after button pin welded with cable. Gauge can be directly connected with DC12/24V power supply.
5. Link wiring harness(#V) at gauge port
6. Press button and adjust time.
7. This clock gauge has no backup battery in itself, so please connect clock gauge with incessant power. Time should be re-adjusted if incessant power is changed.

### 安装步骤

1. 在您的船舱板或仪表板面板(# II)上开一个直径52 mm和直径12mm的孔。
2. 将仪表(# III)装入面板(# II)中, 再用固定圈(# I)旋紧即可。
3. 将按钮(# IV)装入面板(# II)中, 再用螺母锁紧。
4. 按接线图将电线连接好, 按钮的引脚与电线焊接好后, 请套上热缩管。仪表可直接连接到DC12/24V的电源上。
5. 将线束(#V)接入仪表端口中。
6. 按动按钮, 调整到正确的时间。
7. 时钟表本身无备用电池, 故请将时钟表电源直接连接到不断电的电源上! 如果更换电源, 则在重新上电后需要重新调整时间。