

Φ85-87mm(3-2/5")

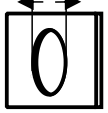

A

如A图，在准备安装仪表面板上开孔Φ85~87mm，并保证面板后面有至少70mm的空间。
Pic A : Before installation , firstly ,to open a hole (Dia:85~87mm) of the panel, make sure there is a space with (70mm backyard of panel) as well

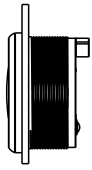

B

如B图，拧开后盖，然后将仪表放入开好孔的仪表面板中
PicB: Twist off the cover then put the gauge in hole

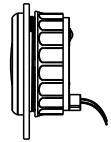

C

如C图，将仪表调整好位置后用仪表后盖将仪表锁紧在仪表面板上
Pic C: Mount the guage in hole, twist the back cover on after adjustment.

仪表功能说明：

- 1) 按轻按Set按键(小于1秒)一次，改变背光颜色: 背光顺序红色(默认) →绿 →蓝 →白 →黄 → 黄绿 →橙 → 紫 → (自动)。自动：设置为自动背光时背光熄灭2秒再点亮，然后1分钟自动切换一次背光颜色。照上面顺序循环切换
- 2) MODE按键按住3秒按，进入小四位数字显示模式设置，然后短按MODE按键，在TRIP01 TRIP02 COG三个模式切换显示方式。

切换方式：TRIP 01：出厂默认，小计里程掉电自动清理，数据不存储，
TRIP 02：小计里不清零，按住Set按键3-5秒清零
COG 00：显示方位角度，即时显示，数据不存储

注意：TRIP显示里程时，与总里程和速度表外圈单位相同。

3)、故障模式：

COG TRIP 在无GPS有效定位信号时闪烁，TRIP四位数字开始计时，每秒加1。300秒无有效信号显示：

E01：启动一直无有效信号

E02：正常工作后 无有效信号（中途丢失信号30秒内，保持信号丢失前的速度，30秒后无信号，速度清零）

E03：10S内接收不到模块数据（中途丢失信号10秒内，保持信号丢失前的速度，10秒后无信号，速度清零）

Operation::

1) Press the Set button(less than 1 second) to change the back light color.

Color in sequence : Red(Default)->Green->Blue->White->Yellow->Kelly->Orange->Purple->Auto Mode

Remarks : When users select the AUTO MODE, the backlight will be off for around two seconds, and switch automatically as above sequence per minute.

2) Hold the MODE button for three seconds for Switch TRIP01 or TRIP02 or COG to display.

TRIP 01(Default): total mileage for one working cycle, data will not be recorded when power off

TRIP 02: total mileage for one working cycle, data will be recorded when power off,but, users could hold the set button for 3~5 seconds to clear.

COG 00: azimuth instantly indicating, data will not be recorded.

Remarks: The unit of trip ,total mileage and outta unit of dial are the same.

3) Malfunction:

Characters "COG" "TRIP" will be flickering when there is not any positive GPS signal.

When the GPS speedometer was connected ,it will search any posotive GPS signal in 300 seconds. And it will account automatically second by second, displaying at the trip part.

Explanation:

E01: There is not any positive GPS signal although it is on

E02: Firstly the speedometer works well but suddenly lost signal (The gauges will display the same speed as previous if the GPS signal back again in 30 seconds,or, speedometer will return to be zero)

E03: The speedometer could not receive any data from internal. (The gauges will display the same speed as previous if the GPS signal back again in 10 seconds,or, speedometer will return to be zero)

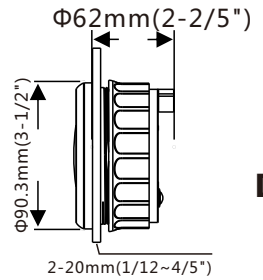

D

如D图，关于外形尺寸的标注说明

Pic D: Size and annotations



默认TRIP单次累计里程，掉电自动清零
累计里程，掉电数据不清零

接线：

- 1、红色线--+9-32VDC
- 2、NC
- 3、橙色线--背光 (+9~32VDC)
- 4、蓝色线--电源负极 (-)

Connection :

- 1、Red --+9-32VDC
- 2、NC
- 3、Orange--Backlight (+)
- 4、Blue--Ground (-)

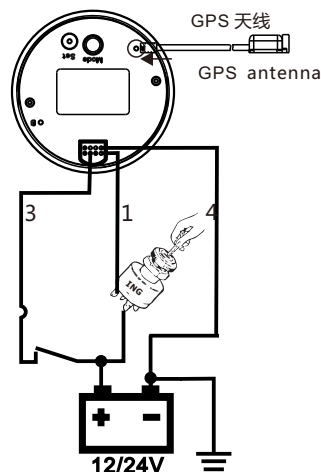

E Wires Connecting



(Default) Trip is for single accumulative total mileage, will be clear when power off.

ODO is for total mileage, will not be clear even the power off

技术参数：

工作电压：9~32VDC，
工作电流：≤100mA(24V)；
工作温度：-30~+75°C
存储温度：-40~+85°C。

Specification :

Operating Voltage : 9~32VDC ,
Operating current : ≤100mA(24V);
Operating temperature : -30~+75°C
Storage temperature : -40~+85°C.